

Kit 1034

MAZDA 323, 4-dr Sedan, 95-97

MAZDA Familia, 4-dr Sedan, 95-97

MAZDA Lantis, 4-dr Sedan, 95-97

480R
754

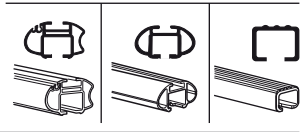
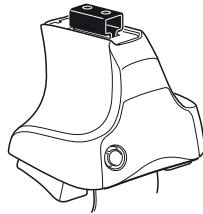

480

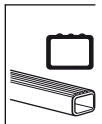
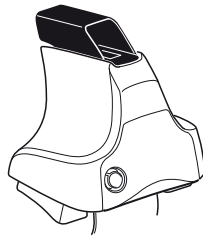

750

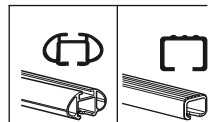
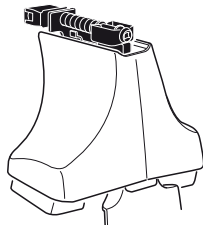

Kit



3

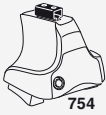

754

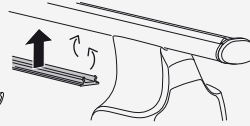
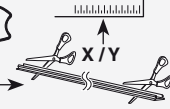

750



1

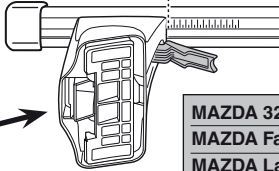

2



	X
MAZDA 323, 4-dr Sedan, 95-97	31,5
MAZDA Familia, 4-dr Sedan, 95-97	31,5
MAZDA Lantis, 4-dr Sedan, 95-97	31,5

1

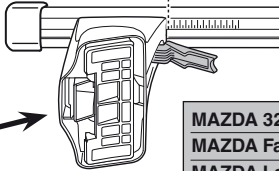

2

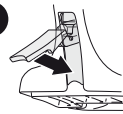

	Y
MAZDA 323, 4-dr Sedan, 95-97	28
MAZDA Familia, 4-dr Sedan, 95-97	28
MAZDA Lantis, 4-dr Sedan, 95-97	28



480R



480

1

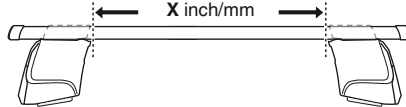
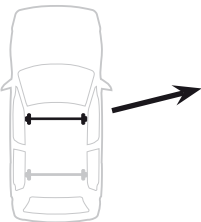

2

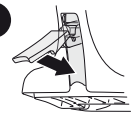

	X inch	X mm
MAZDA 323, 4-dr Sedan, 95-97	38"	966 mm
MAZDA Familia, 4-dr Sedan, 95-97	38"	966 mm
MAZDA Lantis, 4-dr Sedan, 95-97	38"	966 mm

1

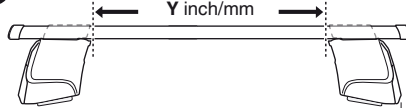
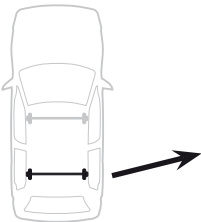

2

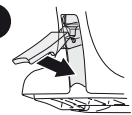

	Y inch	Y mm
MAZDA 323, 4-dr Sedan, 95-97	36 5/8"	931 mm
MAZDA Familia, 4-dr Sedan, 95-97	36 5/8"	931 mm
MAZDA Lantis, 4-dr Sedan, 95-97	36 5/8"	931 mm

4

MAZDA 323, 4-dr Sedan, 95-97
 MAZDA Familia, 4-dr Sedan, 95-97
 MAZDA Lantis, 4-dr Sedan, 95-97

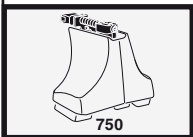
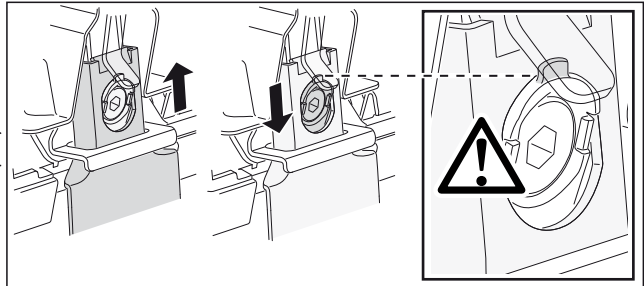
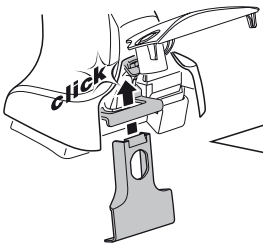
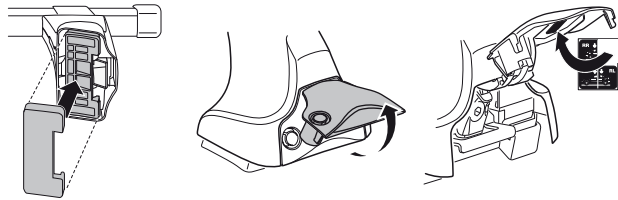
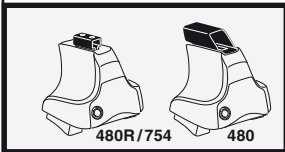
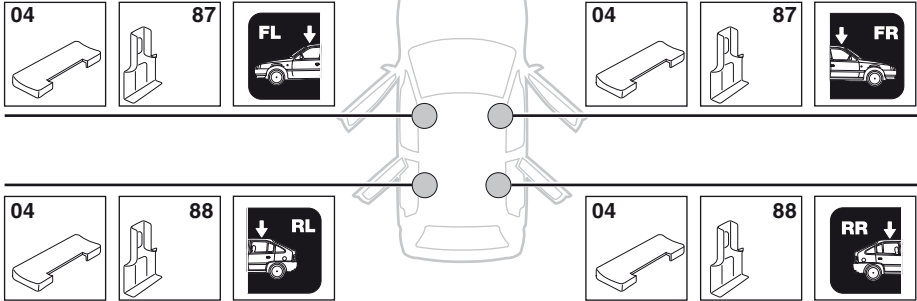

5

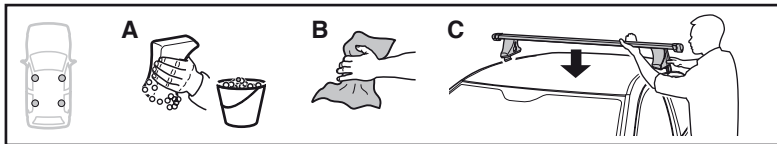

	X mm	Y mm	X inch	Y inch
MAZDA 323, 4-dr Sedan, 95-97	210 mm	650 mm	8 1/4"	25 5/8"
MAZDA Familia, 4-dr Sedan, 95-97	210 mm	650 mm	8 1/4"	25 5/8"
MAZDA Lantis, 4-dr Sedan, 95-97	210 mm	650 mm	8 1/4"	25 5/8"

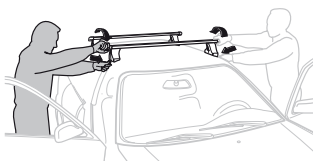
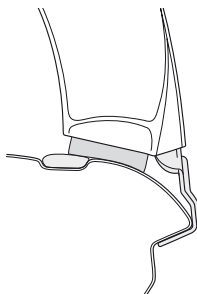
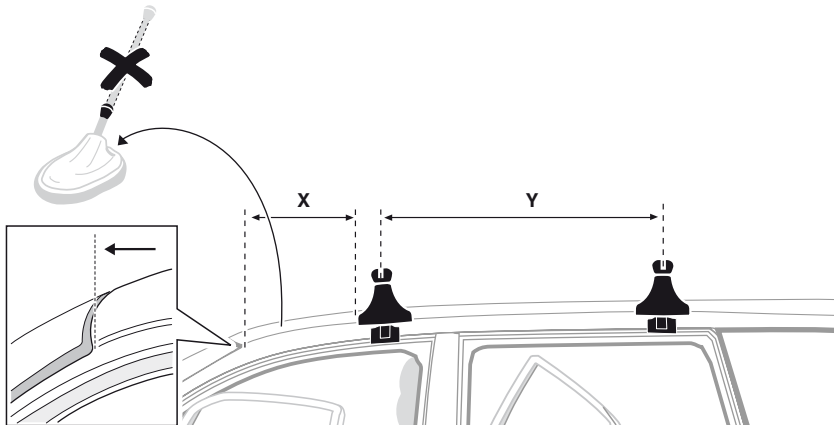

GB/US Tighten alternately

D Die Schrauben abwechselnd anziehen

F Serrer alternativement chaque côté

NL Afwisselend aan de linker- en de rechterkant aandraaien

I Alternare il serraggio delle viti

E Apretar alternativamente

PT Aperte alternadamente

S Dra åt växelvis

FIN Kierrä vuorotellen

EST Pinguldage vaheldumisi

LAT Pievelciēt pamāšus

LIT Užsukinkite pakaitomis

PL Śruby dokręcaj naprzemiennie

RU Затягивайте попеременно

CZ Pokręťta bagażníka dokręcaj dokręcaj naprzemiennie.

SK Dofahujte striedavo

SLO Privijajte izmenično.

HR Naizmjenično zategnite

HU Egy mástól függetlenül szorítandó

GR Σφιγγείτε εναλλάξ

TR Dönüşümlü sıkın

中文 交替拧紧

한국어 번갈아 가며 조이십시오.

日本語 交互に締め付けてください。

ไทย ชั้นในแบบสลับ

6



480R/754



480

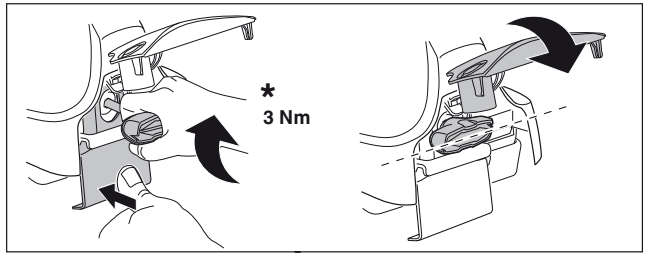
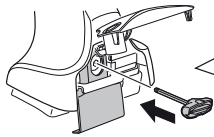

*
3 Nm



*

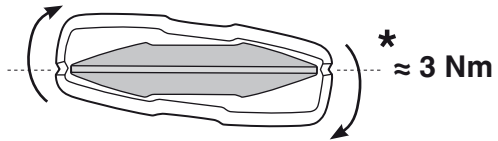

*
≈ 3 Nm

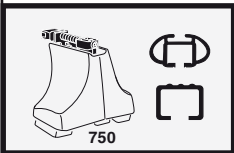
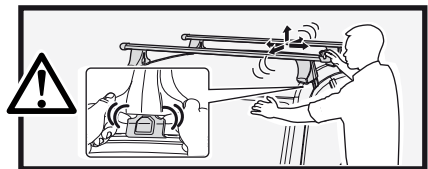

750

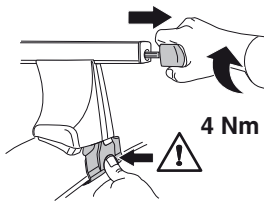

4 Nm

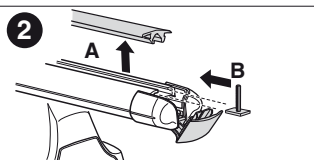
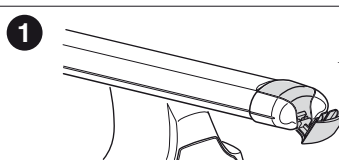
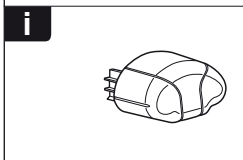
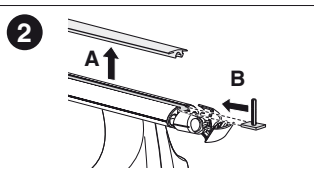
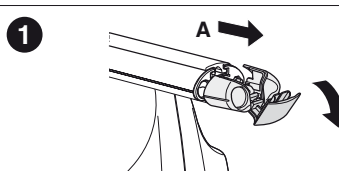
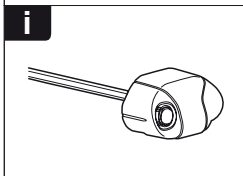
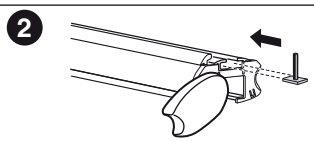
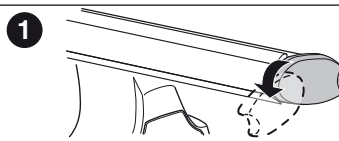
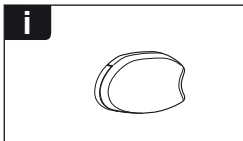
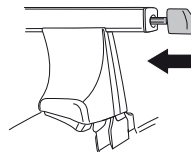

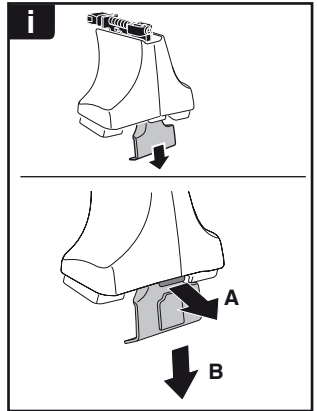
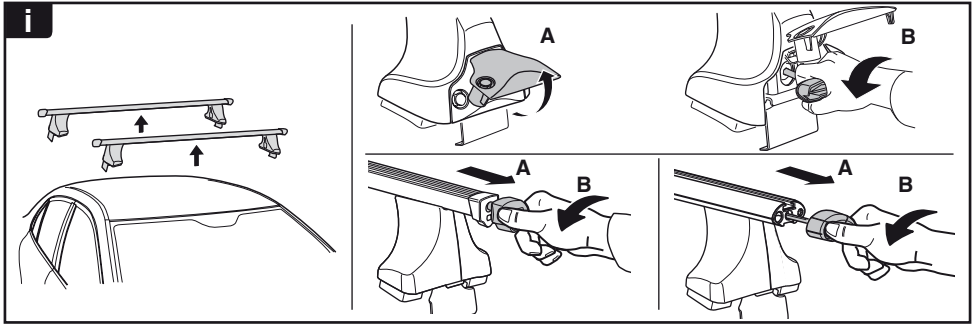

THULE
SWEDEN
**ONE
KEY
SYSTEM**



- 544 (x4)
- 596 (x6)
- 588 (x8)
- NA 510 (x10)
- EUR 452 (x12)
- ASIA



WW ▶ Thule Sweden AB, Box 69, 330 33 Hillerstorp, SWEDEN
 NA ▶ Thule Inc., 42 Silvermine Road, Seymour, Connecticut 06483, USA

info@thule.com
 customer.service@thule.com

www.thule.com